

C-1700N MATRIX Product Selection Guide

Base Price \$509.39

C17N

STROKES PER MINUTE

- 0 = 14.....\$10.09
- 1 = 30.....0.00
- 2 = 45.....0.00
- 3 = 60.....0.00
- 4 = 125.....0.00

INPUT VOLTAGE

- 0 = 115V60Hz impedance protected \$0.00
- 1 = 220V50Hz impedance protected 6.40
- 2 = 230V60Hz impedance protected 0.00
- 3 = 24V60Hz impedance protected 0.00
- 4 = 115V60Hz thermally protected 23.12
- 5 = 220V50Hz thermally protected 29.52
- 6 = 230V60Hz thermally protected 23.12
- A = 240V50Hz thermally protected 6.40

CAM STROKE LENGTH

- 1 = .125" offset
- 2 = .055" offset
- 3 = .187" offset
- 4 = .100" offset

ELECTRONIC CONTROLS

- X = Standard equipment \$0.00
- A = Junction box 0.00
- B = On/Off switch 8.53
- I = 5 second cycle timer 43.04
- K = 1 minute cycle timer 43.04
- P = Power cord and junction box 12.59
- R = 230V power cord 8.52

PUMP HEAD MATERIAL

- 0 = Molded polypropylene..... \$0.00
- 4 = Machined Teflon 226.42
- 5 = Machined Acrylic..... 38.99

FOOTVALVE

- 0 = C-340 (PVDF/Polypro)..... \$0.00
- 1 = C-345 (PVDF/Polypro, Bulkhead) 0.00
- 2 = C-340-6T (Teflon)..... 105.47

INJECTION FITTINGS

- 0 = A-014N (Polypro 1/2 lb spring) \$0.00
- 1 = C-395N (Polypro 6 lb spring) 0.00
- 7 = A-014PN (PP 1/2 lb, short depth) 0.00
- 8 = C-395PN (PP 6 lb, short depth) 0.00
- A = A-014-6T (Teflon 1/2 lb spring) 81.66
- B = C-395N-6T (Teflon 6 lb spring) 81.66
- C = A-014NK (PVDF 1/2 lb spring) 14.91
- D = C-395NK (PVDF 6 lb spring) 14.91
- X = None

ELASTOMERS

- V = Viton/Aflas \$0.00
- E = EP (Ethylene Propylene) 0.00

DIAPHRAGM STYLE

- 0 = Large Teflon coated EP \$0.00
- 1 = Large Teflon coated Viton 18.49
- 6 = Small Teflon coated EP 0.00
- 7 = Small Teflon coated Viton 18.49

PUMP HEAD STYLE

- 0 = Large diaphragm \$0.00
- 2 = Small diaphragm 0.00
- 4 = Large diaphragm carwash package 0.00
- 5 = Large pressure relief 62.58
- 6 = Small diaphragm carwash package 0.00

C-1700N Replacement Parts List

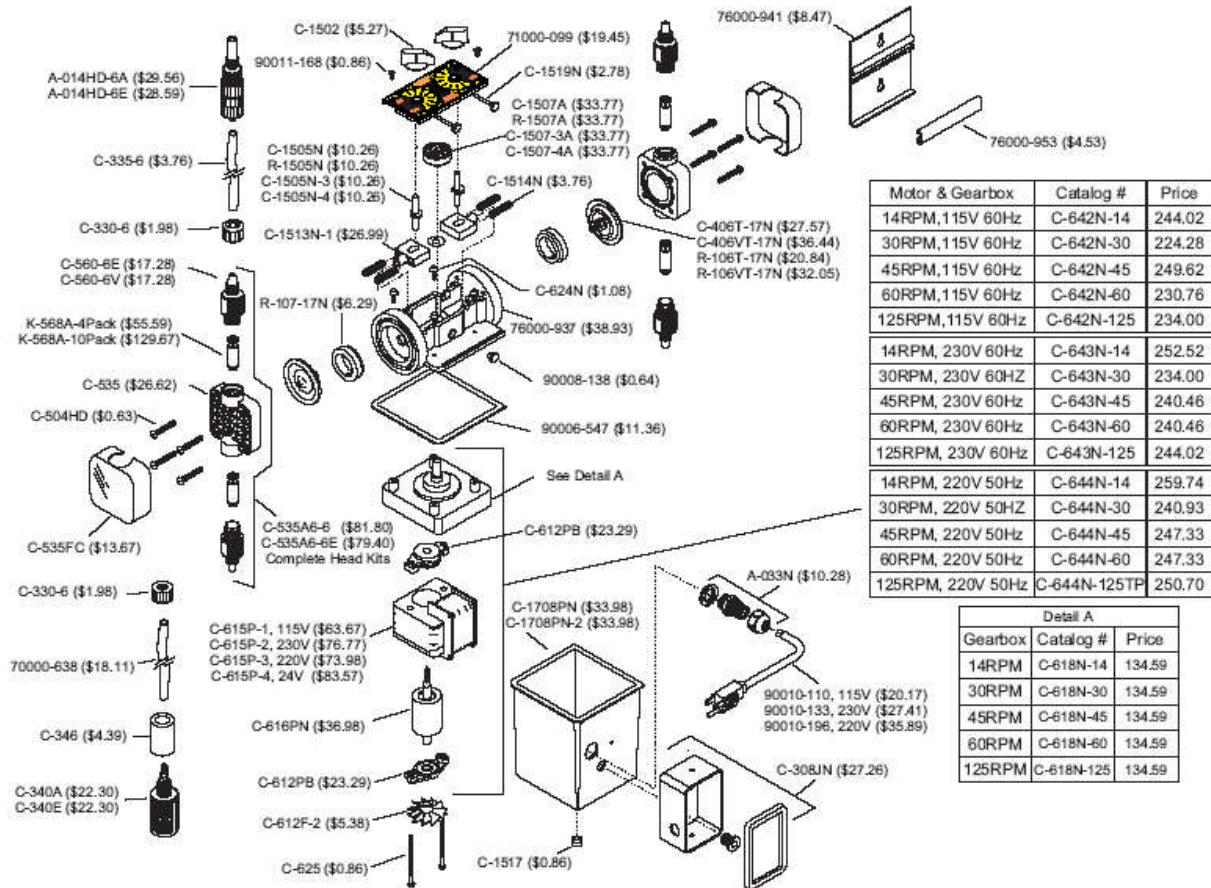

Motor & Gearbox	Catalog #	Price
14RPM, 115V 60Hz	C-642N-14	244.02
30RPM, 115V 60Hz	C-642N-30	224.28
45RPM, 115V 60Hz	C-642N-45	249.62
60RPM, 115V 60Hz	C-642N-60	230.76
125RPM, 115V 60Hz	C-642N-125	234.00
14RPM, 230V 60Hz	C-643N-14	252.52
30RPM, 230V 60Hz	C-643N-30	234.00
45RPM, 230V 60Hz	C-643N-45	240.46
60RPM, 230V 60Hz	C-643N-60	240.46
125RPM, 230V 60Hz	C-643N-125	244.02
14RPM, 220V 50Hz	C-644N-14	259.74
30RPM, 220V 50Hz	C-644N-30	240.93
45RPM, 220V 50Hz	C-644N-45	247.33
60RPM, 220V 50Hz	C-644N-60	247.33
125RPM, 220V 50Hz	C-644N-125TP	250.70

Detail A		
Gearbox	Catalog #	Price
14RPM	C-618N-14	134.59
30RPM	C-618N-30	134.59
45RPM	C-618N-45	134.59
60RPM	C-618N-60	134.59
125RPM	C-618N-125	134.59